

Long Term Operation and Maintenance Plan
Comstock Industrial
Cranston, Rhode Island
April 12, 2022

The project was designed with guidance and direction from the Rhode Island Stormwater Design and Installation Standards Manual (the “Stormwater Manual”), Amended March 2015, by the Rhode Island Department of Environmental Management (RIDEM). Guidance was specifically obtained from the following sections of the Stormwater Manual:

- Section 3.2.11 Minimum Standard 11: Stormwater Management System Operation and Maintenance
- Appendix E: Guidance for Developing Operation and Maintenance Plans

An essential component of a successful stormwater system is the ongoing operation and maintenance of the various components of the stormwater drainage, control, and conveyance systems. Failure to provide effective maintenance can reduce the hydraulic capacity and the pollutant removal efficiency of stormwater practices.

Many people expect that stormwater facilities will continue to function correctly as designed forever. However, it is inevitable that deterioration of the stormwater infrastructure will occur once it becomes operational. The question is not whether stormwater management system maintenance is necessary but how often. Ideally, a program shall address operation and maintenance concerns proactively instead of reacting to problems that occur such as flooding or water quality degradation associated with erosion, clogging, or outright failure of one or more practices. Thus, on-going maintenance is a vital part of ensuring the operational success of stormwater management facilities and is critical to achieving an extended service life of continuous operation as designed.

Stormwater Management System Owners

The owner of the development will be:

Comstock Industrial, LLC
36 Sherwood Place
Greenwich, CT 06830
(203)-292-1850

Party Responsible for Operation and Maintenance

As the property owner, Comstock Industrial is ultimately responsible for the operation and maintenance of the stormwater system. It is not known at this time who the property management firm will be.

BMP Tasks

Inspections will be performed on a scheduled basis, as well as after major rainfall events for those components deemed to be critically affected by the resulting runoff. For the underground pipe network, video equipment will be required.

It is not mandatory that all inspectors be trained engineers, but they shall have some knowledge or experience with stormwater systems.

The inspection process will document observations made in the field and cover structural conditions, hydraulic operational conditions, evidence of vandalism, condition of vegetation, occurrence of obstructions, unsafe conditions, and build-up of trash, sediments and pollutants.

Maintenance Scheduling and Performance

Maintenance activities are divided into two types: scheduled and corrective. Scheduled maintenance tasks are those that are typically accomplished on a regular basis and can generally be scheduled without referencing inspection reports. These items consist of such things as vegetation maintenance (such as mowing) and trash and debris removal. These tasks are required at well-defined time intervals and shall be considered a requirement for most, if not all, stormwater structural facilities. A maintenance crew is typically given a fixed scope of responsibility to address these items.

Corrective tasks consist of items such as sediment removal and outlet structure repairs that are done on an as-needed basis. These tasks will be scheduled based on inspection results or in response to complaints. Corrective maintenance may call for more specialized expertise and equipment than scheduled tasks. For example, a task such as sediment removal from the sediment forebays may require specialized equipment.

Sediment Forebays and Bioretention Areas

During the six months immediately after construction, sediment forebays and bioretention basins shall be inspected at least twice or more following precipitation events of at least 1.0 inch to ensure that the system is functioning properly. Thereafter, inspections shall be conducted on an annual basis and after storm events of greater than 2.6 inches.

Minor soil erosion gullies shall be repaired when they occur. Pruning or replacement of woody vegetation shall occur when dead or dying vegetation is observed.

Separation of herbaceous vegetation rootstock shall occur when over-crowding is observed, or approximately once every 3 years. The mulch layer shall also be replenished (to the original design depth) every other year, as directed by inspection reports. The previous mulch layer shall be removed, and properly disposed of, or roto-tilled into the soil surface. If at least 50 percent vegetation coverage is not established after two years, a reinforcement planting shall be performed. If the surface of the bioretention system becomes clogged to the point that standing water is observed on the surface 48 hours after precipitation events, the surface shall be roto-tilled or cultivated to breakup any hard-packed sediment and then re-vegetated.

Catch Basins

During the six months immediately after construction, storm structures shall be inspected at least twice or more following precipitation events of at least 1.0 inch to ensure that the system is functioning properly. Thereafter, inspections shall be conducted on a semi-annual basis and after storm events of greater than 2.6 inches.

All stormwater inlets are to be cleaned using a vacuum truck twice per year or when the sump is half full of debris and/or silt.

Underground Detention Chambers (StormTrap)

During the six months immediately after construction, storm chambers shall be inspected at least twice or more following precipitation events of at least 1.0 inch to ensure that the system is functioning properly. Thereafter, inspections shall be conducted on an annual basis and after storm events of greater than 2.6 inches.

All stormwater chambers are to be cleaned using a vacuum truck once per year or when the sump is half full of debris and/or silt.

Jellyfish Filter Unit

Jellyfish filter units shall be maintained in accordance with the manufacturer's (Contech Engineered Solutions) recommendations. The Jellyfish Filter Owner's Manual has been attached to this report as Attachment C. See Chapter 3 of the Owner's Manual for Inspection and Maintenance Overview, Chapter 6 for Maintenance Requirements, and Chapter 7 for Maintenance Procedures.

CDS Unit

CDS filter units shall be maintained in accordance with the manufacturer's (Contech Engineered Solutions) recommendations. The CDS Guide; Operation, Design, Performance, and Maintenance has been attached to this report as Attachment C. See Pag 4 of the Guide for Maintenance and Inspection.

Inspection checklists have been included as Attachment A.

BMP Plan showing the location of all stormwater practices requiring maintenance has been included as Attachment D.

Long-Term Pollution Prevention

Pollution prevention and source controls are a significant part in the stormwater management design especially near a residential development. One important technique includes the use of trash racks at all of the outlet control structures in the bioretention areas.

Another source control is the regular collection of trash and recycling at all sites. The site will contain dumpster and recycling locations near the buildings. These dumpsters will be collected regularly by the appropriate dump truck.

Sand and deicing salt will be utilized for safety during winter storms. The information provided in *Table G-1 Comparison of Environmental Effects of Common Roadway Deicers* will be considered when selecting a deicer. The site will also include quarterly (four times per year) parking lot sweeping. Additionally, snow disposal locations have been identified on Sheet C-2.1-2.2 of the plan set. There will not be any snow dumping into waterbodies, wellhead protection areas, sanitary landfills, or on top of storm drain inlets.

There are minimal grassed and landscape areas at the proposed development. These landscaped areas will not be fertilized more than twice per year in accordance with Appendix G of the *Rhode*

Island Stormwater Design and Installation Standards Manual (RISDISM). Since the landscape areas are small in size it is anticipated that weeds can be dug or pulled out and that chemical herbicides will not be necessary.

Estimated Operation and Maintenance Budget

The regular maintenance operations will be performed by either the full-time property management staff (above-ground inspections, debris removal, etc.) or outside landscape contractors (mowing) as part of their operating budget. It is anticipated that the stormwater inspection portion of their regular duties will be minor. It is estimated that vacuum truck contracting for the chambers' sediment removal will be required every few years and that will cost \$10,000 per year.

Funding Source for Operation and Maintenance Budget

The operation and maintenance budget will be funded as part of the property management budget, which will ultimately be funded by Comstock Industrial.

Attachment A Inspection Checklists

**Bioretention Operation, Maintenance, and
Management Inspection Checklist**

Project:

Location:

Site Status:

Date:

Time:

Inspector:

MAINTENANCE ITEM	SATISFACTORY / UNSATISFACTORY	COMMENTS
1. Debris Cleanout (Annual, After Major Storms)		
Bioretention and contributing areas clean of debris		
No dumping of yard wastes into practice		
Litter (branches, etc.) have been removed		
2. Vegetation (Annual, After Major Storms)		
Plant height not less than design water depth		
Fertilized per specifications		
Plant composition according to approved plans		
No placement of inappropriate plants		
Grass height not greater than 10 inches		

MAINTENANCE ITEM	SATISFACTORY / UNSATISFACTORY	COMMENTS
No evidence of erosion		
3. Check Dams/Energy Dissipaters/Sumps (Annual, After Major Storms)		
No evidence of sediment buildup		
Sumps should not be more than 50% full of sediment		
No evidence of erosion at downstream toe of drop structure		
4. Dewatering (Semi-annually)		
Dewaters between storms		
No evidence of standing water		
5. Sediment Deposition (Annual, after Major Storms)		
Swale clean of sediments		
Sediments should not be > 20% of swale design depth		
6. Outlet/Overflow Spillway (Annual, After Major Storms)		
Good condition, no need for repair		
No evidence of erosion		
No evidence of any blockages		
7. Integrity of Filter Bed (Annual, After Major Storms)		
Filter bed has not been blocked or filled inappropriately		

Comments:

Actions to be Taken:

Attachment B
BMP Location Map

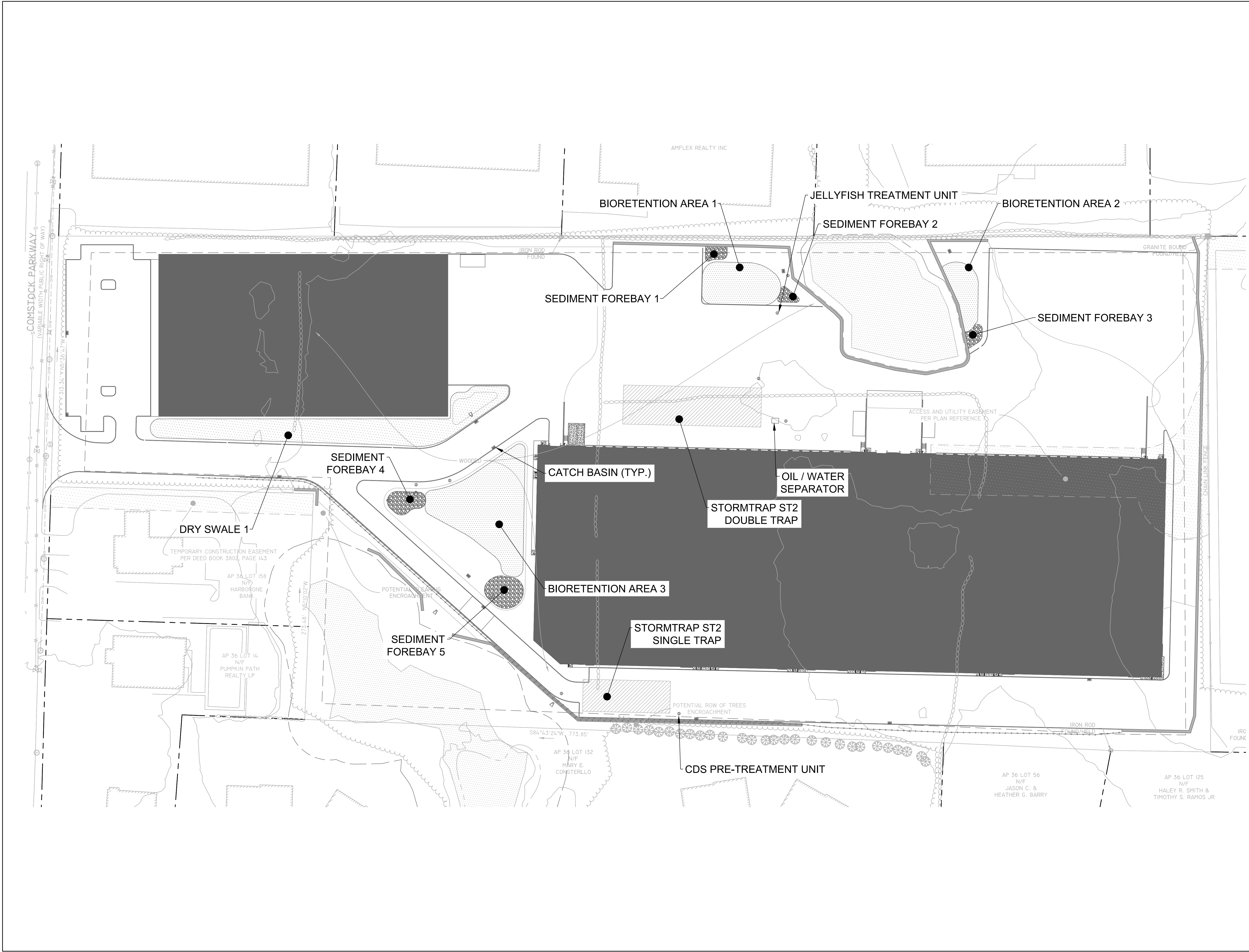

COMSTOCK INDUSTRIAL PARK

COMSTOCK PARKWAY

CRANSTON, RI

PLAT 36/4 LOT 46

DATE:	REVISION:
7/8/2022	PER RIDEM COMMENTS
8/8/2022	PER RIDEM COMMENTS

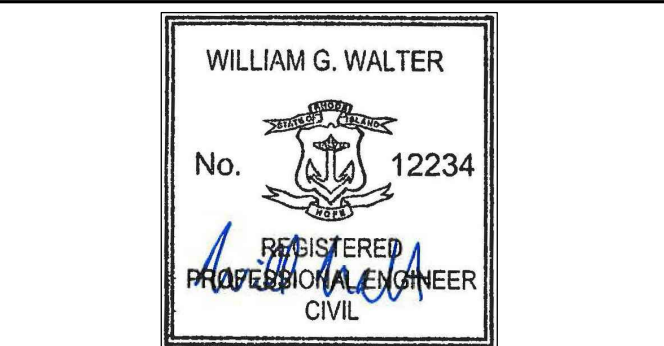
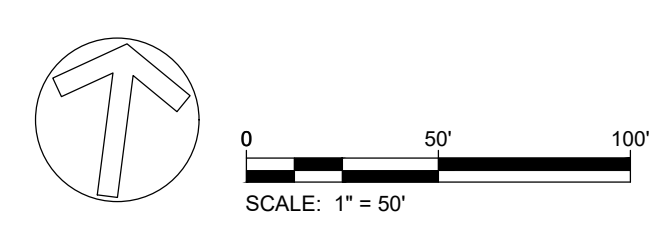
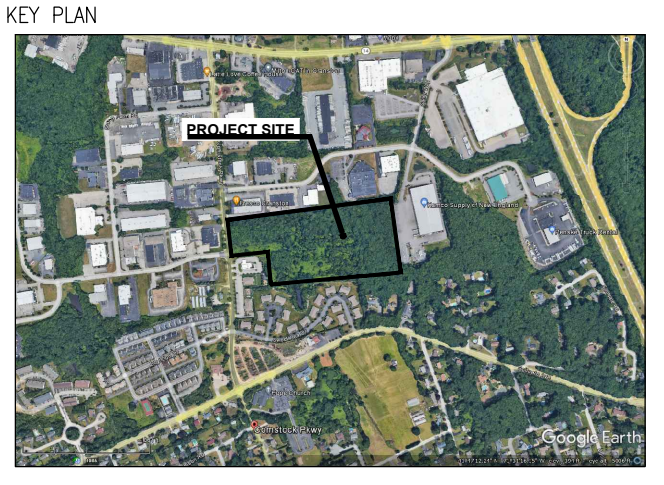

PROJECT NO.: 70753.00
SCALE: AS NOTED
DATE: 04/12/2022

DRAWN BY: GSL
CHECKED BY: WGW

BEST MANAGEMENT PRACTICE AREA MAP

DRAWING NO.: **BMP**

Attachment C
Jellyfish Filter Owner's Manual
CDS Guide

**Jellyfish[®] Filter
Owner's Manual**



Table of Contents

Chapter 1	1.0 Owner Specific Jellyfish Product Information.....	4
Chapter 2	2.0 Jellyfish Filter System Operations & Functions	5
	2.1 Components & Cartridges	6
	2.2 Jellyfish Membrane Filtration Cartridges Assembly	7
	2.3 Installation of Jellyfish Membrane Filtration Cartridges.....	7
Chapter 3	3.0 Inspection and Maintenance Overview	8
Chapter 4	4.0 Inspection Timing	8
Chapter 5	5.0 Inspection Procedure.....	8
	5.1 Dry Weather Inspections	8
	5.1 Wet Weather Inspections	9
Chapter 6	6.0 Maintenance Requirements.....	9
Chapter 7	7.0 Maintenance Procedure	9
	7.1 Filter Cartridge Removal	9
	7.2 Filter Cartridge Rinsing	9
	7.3 Sediment and Flotables Extraction	10
	7.4 Filter Cartridge Reinstallation and Replacement.....	10
	7.5 Chemical Spills.....	10
	7.6 Material Disposal	10
	Jellyfish Filter Inspection and Maintenance Log	12

THANK YOU FOR PURCHASING THE JELLYFISH® FILTER!

Contech Engineered Solutions would like to thank you for selecting the Jellyfish Filter to meet your project's stormwater treatment needs. With proper inspection and maintenance, the Jellyfish Filter is designed to deliver ongoing, high levels of stormwater pollutant removal.

If you have any questions, please feel free to call us or e-mail us:

Contech Engineered Solutions

9025 Centre Pointe Drive, Suite 400 | West Chester, OH 45069

513-645-7000 | 800-338-1122

www.ContechES.com

info@conteches.com

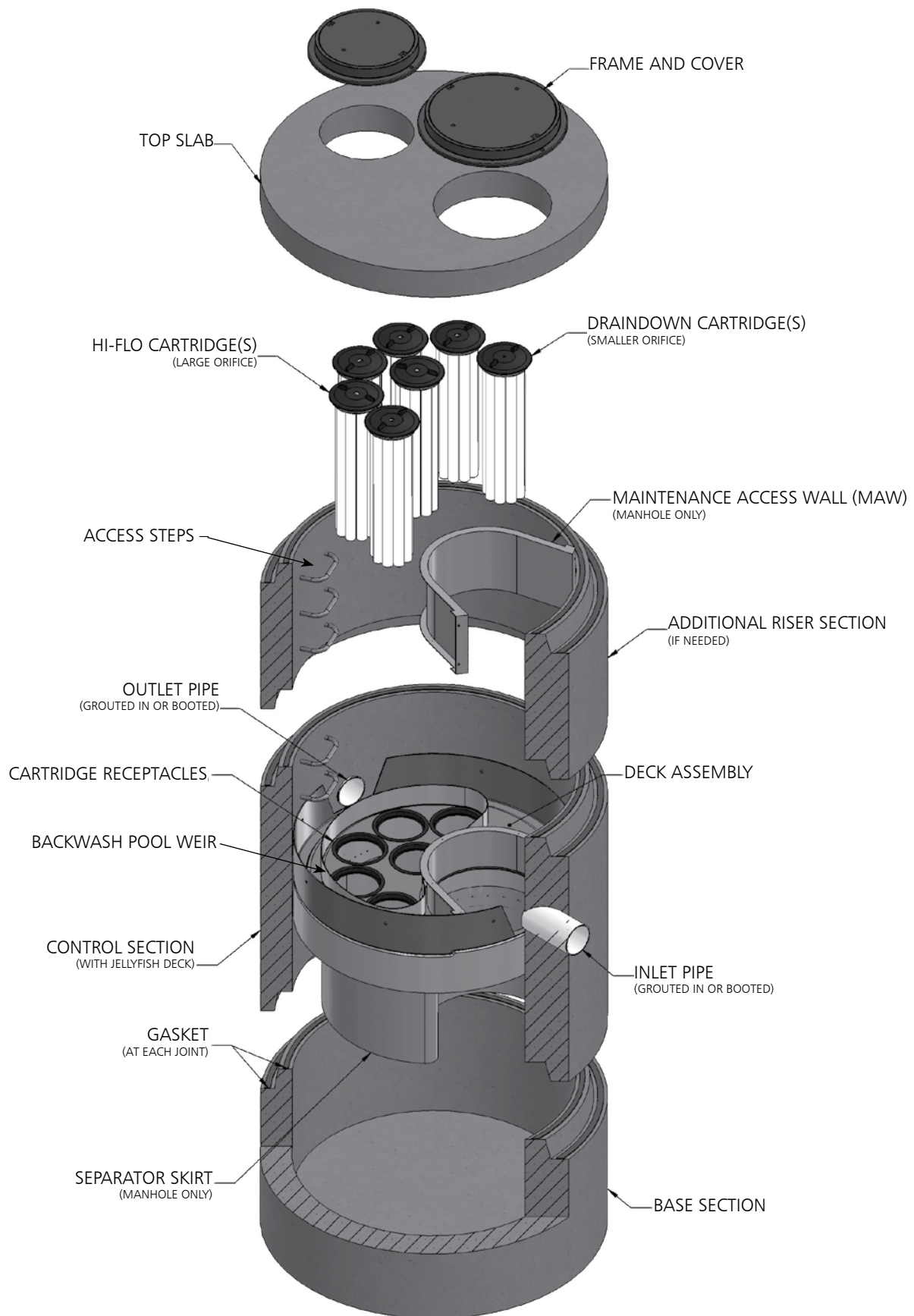

WARNINGS / CAUTION

1. FALL PROTECTION may be required.
2. WATCH YOUR STEP if standing on the Jellyfish Filter Deck at any time; Great care and safety must be taken while walking or maneuvering on the Jellyfish Filter Deck. Attentive care must be taken while standing on the Jellyfish Filter Deck at all times to prevent stepping onto a lid, into or through a cartridge hole or slipping on the deck.
3. The Jellyfish Filter Deck can be SLIPPERY WHEN WET.
4. If the Top Slab, Covers or Hatches have not yet been installed, or are removed for any reason, great care must be taken to NOT DROP ANYTHING ONTO THE JELLYFISH FILTER DECK. The Jellyfish Filter Deck and Cartridge Receptacle Rings can be damaged under high impact loads. This type of activity voids all warranties. All damaged items to be replaced at owner's expense.
5. Maximum deck load 2 persons, total weight 450 lbs.

Safety Notice

Jobsite safety is a topic and practice addressed comprehensively by others. The inclusions here are intended to be reminders to whole areas of Safety Practice that are the responsibility of the Owner(s), Manager(s) and Contractor(s). OSHA and Canadian OSH, and Federal, State/Provincial, and Local Jurisdiction Safety Standards apply on any given site or project. The knowledge and applicability of those responsibilities is the Contractor's responsibility and outside the scope of Contech Engineered Solutions.

Confined Space Entry

Secure all equipment and perform all training to meet applicable local and OSHA regulations regarding confined space entry. It is the Contractor's or entry personnel's responsibility to proceed safely at all times.

Personal Safety Equipment

Contractor is responsible to provide and wear appropriate personal protection equipment as needed including, but not limited to safety boots, hard hat, reflective vest, protective eyewear, gloves and fall protection equipment as necessary. Make sure all equipment is staffed with trained and/or certified personnel, and all equipment is checked for proper operation and safety features prior to use.

- Fall protection equipment
- Eye protection
- Safety boots
- Ear protection
- Gloves
- Ventilation and respiratory protection
- Hard hat
- Maintenance and protection of traffic plan

Chapter 1

1.0 – Owner Specific Jellyfish Filter Product Information

Below you will find a reference page that can be filled out according to your Jellyfish Filter specification to help you easily inspect, maintain and order parts for your system.

Owner Name:	
Phone Number:	
Site Address:	
Site GPS Coordinates/unit location:	
Unit Location Description:	
Jellyfish Filter Model No.:	
Contech Project & Sequence Number	
No. of Hi-Flo Cartridges	
No. of Cartridges:	
Length of Draindown Cartridges:	
No. of Blank Cartridge Lids:	
Bypass Configuration (Online/Offline):	

Notes:

Chapter 2

2.0 – Jellyfish Filter System Operations and Functions

The Jellyfish Filter is an engineered stormwater quality treatment technology that removes a high level and wide variety of stormwater pollutants. Each Jellyfish Filter cartridge consists of eleven membrane - encased filter elements (“filtration tentacles”) attached to a cartridge head plate. The filtration tentacles provide a large filtration surface area, resulting in high flow and high pollutant removal capacity.

The Jellyfish Filter functions are depicted in Figure 1 below.

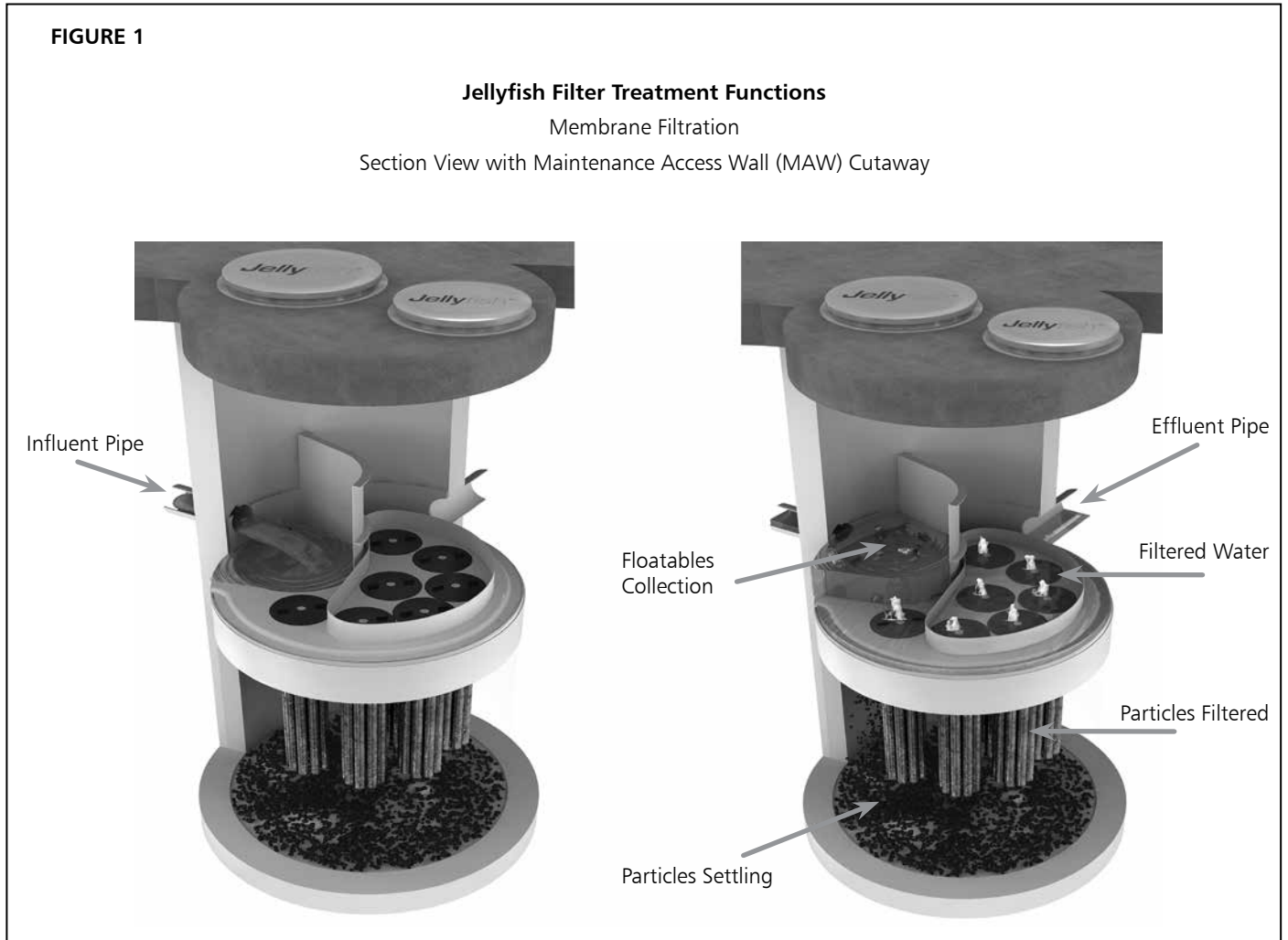

Jellyfish Filter cartridges are backwashed after each peak storm event, which removes accumulated sediment from the membranes. This backwash process extends the service life of the cartridges and increases the time between maintenance events.

For additional details on the operation and pollutant capabilities of the Jellyfish Filter please refer to additional details on our website at www.ContechES.com.

2.1 – Components and Cartridges

The Jellyfish Filter and components are depicted in Figure 2 below.

FIGURE 2

Jellyfish Filter Components

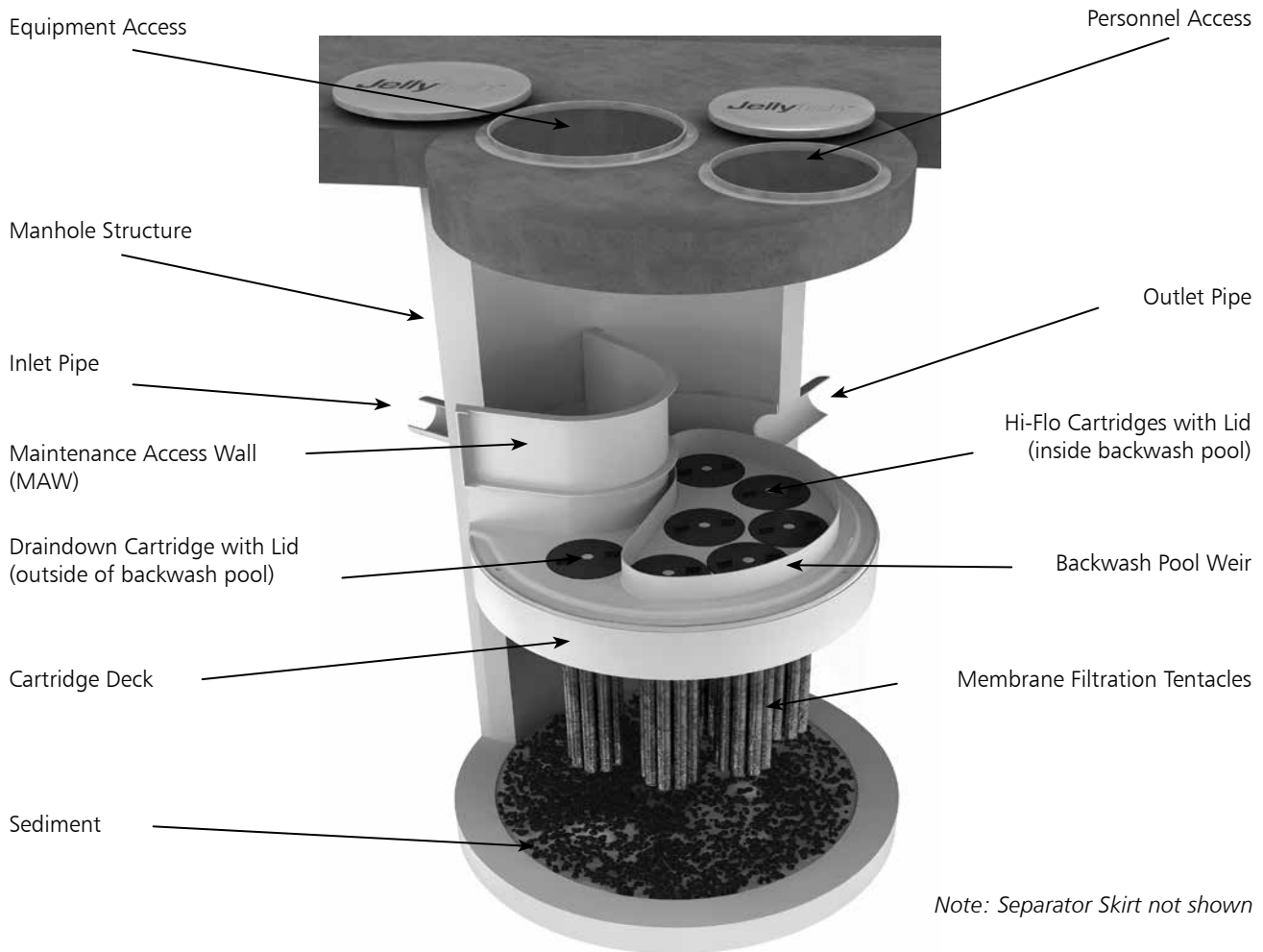

Tentacles are available in various lengths as depicted in Table 1 below.

Table 1 – Cartridge Lengths / Weights and Cartridge Lid Orifice Diameters

Cartridge Lengths	Dry Weight	Hi-Flo Orifice Diameter	Draindown Orifice Diameter
15 inches (381 mm)	10 lbs (4.5 kg)	35 mm	20 mm
27 inches (686 mm)	14.5 lbs (6.6 kg)	45 mm	25 mm
40 inches (1,016 mm)	19.5 lbs (8.9 kg)	55 mm	30 mm
54 inches (1,372 mm)	25 lbs (11.4 kg)	70 mm	35 mm

2.2 – Jellyfish Membrane Filtration Cartridge Assembly

The Jellyfish Filter utilizes multiple membrane filtration cartridges. Each cartridge consists of removable cylindrical filtration “tentacles” attached to a cartridge head plate. Each filtration tentacle has a threaded pipe nipple and o-ring. To attach, insert the top pipe nipples with the o-ring through the head plate holes and secure with locking nuts. Hex nuts to be hand tightened and checked with a wrench as shown below.

2.3 – Jellyfish Membrane Filtration Cartridge Installation

- Cartridge installation will be performed by trained individuals and coordinated with the installing site Contractor. Flow diversion devices are required to be in place until the site is stabilized (final paving and landscaping in place). Failure to address this step completely will reduce the time between required maintenance.
- Descend to the cartridge deck (see Safety Notice and page 3).
- Refer to Contech's submittal drawings to determine proper quantity and placement of Hi-Flo, Draindown and Blank cartridges with appropriate lids. Lower the Jellyfish membrane filtration cartridges into the cartridge receptacles within the cartridge deck. It is possible that not all cartridge receptacles will be filled with a filter cartridge. In that case, a blank headplate and blank cartridge lid (no orifice) would be installed.



Cartridge Assembly

Do not force the tentacles down into the cartridge receptacle, as this may damage the membranes. Apply downward pressure on the cartridge head plate to seat the lubricated rim gasket (thick circular gasket surrounding the circumference of the head plate) into the cartridge receptacle. (See Figure 3 for details on approved lubricants for use with rim gasket.)

- Examine the cartridge lids to differentiate lids with a small orifice, a large orifice, and no orifice.
 - Lids with a small orifice are to be inserted into the Draindown cartridge receptacles, outside of the backwash pool weir.
 - Lids with a large orifice are to be inserted into the Hi-Flo cartridge receptacles within the backwash pool weir.
 - Lids with no orifice (blank cartridge lids) and a blank headplate are to be inserted into unoccupied cartridge receptacles.
- To install a cartridge lid, align both cartridge lid male threads with the cartridge receptacle female threads before rotating approximately 1/3 of a full rotation until firmly seated. Use of an approved rim gasket lubricant may facilitate installation.

3.0 Inspection and Maintenance Overview

The primary purpose of the Jellyfish® Filter is to capture and remove pollutants from stormwater runoff. As with any filtration system, these pollutants must be removed to maintain the filter's maximum treatment performance. Regular inspection and maintenance are required to insure proper functioning of the system. Maintenance frequencies and requirements are site specific and vary depending on pollutant loading. Additional maintenance activities may be required in the event of non-storm event runoff, such as base-flow or seasonal flow, an upstream chemical spill or due to excessive sediment loading from site erosion or extreme runoff events. It is a good practice to inspect the system after major storm events.

Inspection activities are typically conducted from surface observations and include:

- Observe if standing water is present
- Observe if there is any physical damage to the deck or cartridge lids
- Observe the amount of debris in the Maintenance Access Wall (MAW) or inlet bay for vault systems

Maintenance activities include:

- Removal of oil, floatable trash and debris
- Removal of collected sediments
- Rinsing and re-installing the filter cartridges
- Replace filter cartridge tentacles, as needed

4.0 Inspection Timing

Inspection of the Jellyfish Filter is key in determining the maintenance requirements for, and to develop a history of, the site's pollutant loading characteristics. In general, inspections should be performed at the times indicated below; *or per the approved project stormwater quality documents (if applicable), whichever is more frequent.*

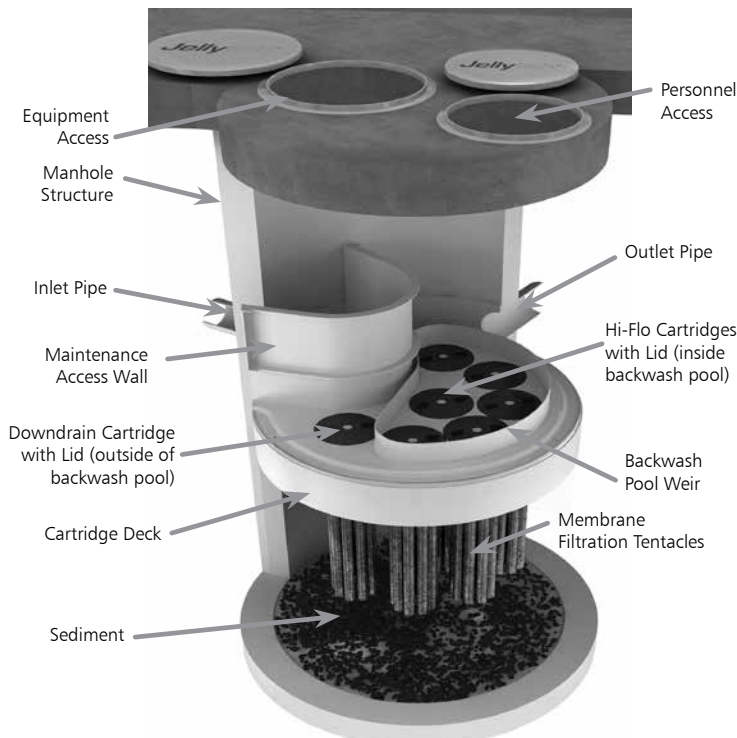

Note: Separator Skirt not shown

1. A minimum of quarterly inspections during the first year of operation to assess the sediment and floatable pollutant accumulation, and to ensure proper functioning of the system.
2. Inspection frequency in subsequent years is based on the inspection and maintenance plan developed in the first year of operation. Minimum frequency should be once per year.
3. Inspection is recommended after each major storm event.
4. Inspection is required immediately after an upstream oil, fuel or other chemical spill.

5.0 Inspection Procedure

The following procedure is recommended when performing inspections:

1. Provide traffic control measures as necessary.
2. Inspect the MAW or inlet bay for floatable pollutants such as trash, debris, and oil sheen.
3. Measure oil and sediment depth in several locations, by lowering a sediment probe until contact is made with the floor of the structure. Record sediment depth, and presences of any oil layers.
4. Inspect cartridge lids. Missing or damaged cartridge lids to be replaced.
5. Inspect the MAW (where appropriate), cartridge deck and receptacles, and backwash pool weir, for damaged or broken components.

5.1 Dry weather inspections

- Inspect the cartridge deck for standing water, and/or sediment on the deck.
- No standing water under normal operating conditions.
- Standing water inside the backwash pool, but not outside the backwash pool indicates, that the filter cartridges need to be rinsed.



Inspection Utilizing Sediment Probe

- Standing water outside the backwash pool is not anticipated and may indicate a backwater condition caused by high water elevation in the receiving water body, or possibly a blockage in downstream infrastructure.
- Any appreciable sediment ($\geq 1/16"$) accumulated on the deck surface should be removed.

5.2 Wet weather inspections

- Observe the rate and movement of water in the unit. Note the depth of water above deck elevation within the MAW or inlet bay.
- Less than 6 inches, flow should be exiting the cartridge lids of each of the draindown cartridges (i.e. cartridges located outside the backwash pool).
- Greater than 6 inches, flow should be exiting the cartridge lids of each of the draindown cartridges and each of the hi-flo cartridges (i.e. cartridges located inside the backwash pool), and water should be overflowing the backwash pool weir.
- 18 inches or greater and relatively little flow is exiting the cartridge lids and outlet pipe, this condition indicates that the filter cartridges need to be rinsed.

6.0 Maintenance Requirements

Required maintenance for the Jellyfish Filter is based upon results of the most recent inspection, historical maintenance records, or the site specific water quality management plan; whichever is more frequent. In general, maintenance requires some combination of the following:

1. Sediment removal for depths reaching 12 inches or greater, or within 3 years of the most recent sediment cleaning, whichever occurs sooner.
2. Floatable trash, debris, and oil removal.
3. Deck cleaned and free from sediment.
4. Filter cartridges rinsed and re-installed as required by the most recent inspection results, or within 12 months of the most recent filter rinsing, whichever occurs sooner.
5. Replace tentacles if rinsing does not restore adequate hydraulic capacity, remove accumulated sediment, or if damaged or missing. It is recommended that tentacles should remain in service no longer than 5 years before replacement.
6. Damaged or missing cartridge deck components must be repaired or replaced as indicated by results of the most recent inspection.
7. The unit must be cleaned out and filter cartridges inspected immediately after an upstream oil, fuel, or chemical spill. Filter cartridge tentacles should be replaced if damaged or compromised by the spill.

7.0 Maintenance Procedure

The following procedures are recommended when maintaining the Jellyfish Filter:

1. Provide traffic control measures as necessary.
2. Open all covers and hatches. Use ventilation equipment as required, according to confined space entry procedures.
Caution: Dropping objects onto the cartridge deck may cause damage.
3. Perform Inspection Procedure prior to maintenance activity.

4. To access the cartridge deck for filter cartridge service, descend into the structure and step directly onto the deck. *Caution: Do not step onto the maintenance access wall (MAW) or backwash pool weir, as damage may result. Note that the cartridge deck may be slippery.*
5. Maximum weight of maintenance crew and equipment on the cartridge deck not to exceed 450 lbs.

7.1 Filter Cartridge Removal

1. Remove a cartridge lid.
2. Remove cartridges from the deck using the lifting loops in the cartridge head plate. Rope or a lifting device (available from Contech) should be used. *Caution: Should a snag occur, do not force the cartridge upward as damage to the tentacles may result. Wet cartridges typically weigh between 100 and 125 lbs.*
3. Replace and secure the cartridge lid on the exposed empty receptacle as a safety precaution. Contech does not recommend exposing more than one empty cartridge receptacle at a time.

7.2 Filter Cartridge Rinsing

1. Remove all 11 tentacles from the cartridge head plate. Take care not to lose or damage the O-ring seal as well as the plastic threaded nut and connector.
2. Position tentacles in a container (or over the MAW), with the



Cartridge Removal & Lifting Device

threaded connector (open end) facing down, so rinse water is flushed through the membrane and captured in the container.

3. Using the Jellyfish rinse tool (available from Contech) or a low-pressure garden hose sprayer, direct water spray onto the tentacle membrane, sweeping from top to bottom along the length of the tentacle. Rinse until all sediment is removed from the membrane. *Caution: Do not use a high pressure sprayer or focused stream of water on the membrane. Excessive water pressure may damage the membrane.*
4. Collected rinse water is typically removed by vacuum hose.

5. Reassemble cartridges as detailed later in this document. Reuse O-rings and nuts, ensuring proper placement on each tentacle.

7.3 Sediment and Floatables Extraction

1. Perform vacuum cleaning of the Jellyfish Filter only after filter cartridges have been removed from the system. Access the lower chamber for vacuum cleaning only through the maintenance access wall (MAW) opening. Be careful not to damage the flexible plastic separator skirt that is attached to the underside of the deck on manhole systems. Do not lower the vacuum wand through a cartridge receptacle, as damage to the receptacle will result.
2. Vacuum floatable trash, debris, and oil, from the MAW opening or inlet bay. Alternatively, floatable solids may be removed by a net or skimmer.
3. Pressure wash cartridge deck and receptacles to remove all



Rinsing Cartridge with Contech Rinse Tool

sediment and debris. Sediment should be rinsed into the sump area. Take care not to flush rinse water into the outlet pipe.

4. Remove water from the sump area. Vacuum or pump equipment should only be introduced through the MAW or inlet bay.
5. Remove the sediment from the bottom of the unit through the MAW or inlet bay opening.
6. For larger diameter Jellyfish Filter manholes (≥ 8 -ft) and some



Vacuuming Sump Through MAW

vaults complete sediment removal may be facilitated by removing a cartridge lid from an empty receptacle and inserting a jetting wand (not a vacuum wand) through the receptacle. Use the sprayer to rinse loosened sediment toward the vacuum hose in the MAW opening, being careful not to damage the receptacle.

7.4 Filter Cartridge Reinstallation and Replacement

1. Cartridges should be installed after the deck has been cleaned. It is important that the receptacle surfaces be free from grit and debris.
2. Remove cartridge lid from deck and carefully lower the filter cartridge into the receptacle until head plate gasket is seated squarely in receptacle. *Caution: Do not force the cartridge downward; damage may occur.*
3. Replace the cartridge lid and check to see that both male threads are properly seated before rotating approximately 1/3 of a full rotation until firmly seated. Use of an approved rim gasket lubricant may facilitate installation. See next page for additional details.
4. If rinsing is ineffective in removing sediment from the tentacles, or if tentacles are damaged, provisions must be made to replace the spent or damaged tentacles with new tentacles. Contact Contech to order replacement tentacles.

7.5 Chemical Spills

Caution: If a chemical spill has been captured, do not attempt maintenance. Immediately contact the local hazard response agency and contact Contech.

7.6 Material Disposal

The accumulated sediment found in stormwater treatment and conveyance systems must be handled and disposed of in accordance with regulatory protocols. It is possible for sediments to contain measurable concentrations of heavy metals and organic chemicals (such as pesticides and petroleum products). Areas with the greatest potential for high pollutant loading include industrial areas and heavily traveled roads. Sediments and water must be disposed of in accordance with all applicable waste disposal regulations. When scheduling maintenance, consideration must be made for the disposal of solid and liquid wastes. This typically requires coordination with a local landfill for solid waste disposal. For liquid waste disposal a number of options are available including a municipal vacuum truck decant facility, local waste water treatment plant or on-site treatment and discharge.

Jellyfish Filter Components & Filter Cartridge Assembly and Installation

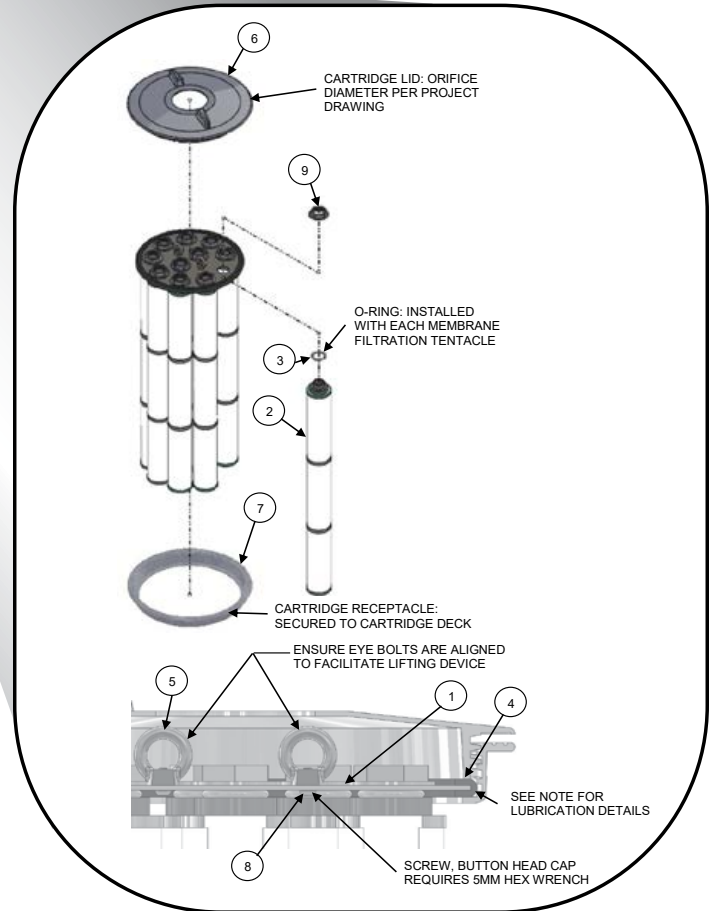
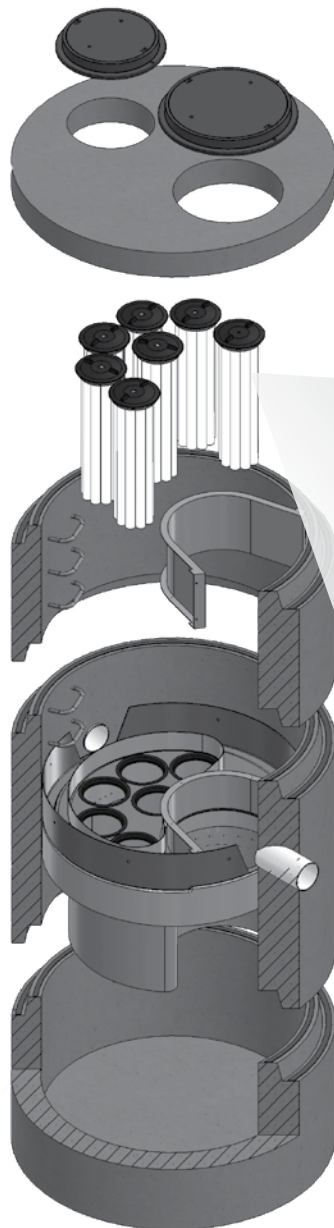

TABLE 1: BOM

ITEM NO.	DESCRIPTION
1	JF HEAD PLATE
2	JF TENTACLE
3	JF O-RING
4	JF HEAD PLATE GASKET
5	JF CARTRIDGE EYELET
6	JF 14IN COVER
7	JF RECEPTACLE
8	BUTTON HEAD CAP SCREW M6X14MM SS
9	JF CARTRIDGE NUT

TABLE 2: APPROVED GASKET LUBRICANTS

PART NO.	MFR	DESCRIPTION
78713	LA-CO	LUBRI-JOINT
40501	HERCULES	DUCK BUTTER
30600	OATEY	PIPE LUBRICANT
PSLUBXL1Q	PROSELECT	PIPE JOINT LUBRICANT

NOTES:

Head Plate Gasket Installation:

Install Head Plate Gasket (Item 4) onto the Head Plate (Item 1) and liberally apply a lubricant from Table 2: Approved Gasket Lubricants onto the gasket where it contacts the Receptacle (Item 7) and Cartridge Lid (Item 6). Follow Lubricant manufacturer's instructions.

Lid Assembly:

Rotate Cartridge Lid counter-clockwise until both male threads drop down and properly seat. Then rotate Cartridge Lid clock-wise approximately one-third of a full rotation until Cartridge Lid is firmly secured, creating a watertight seal.

Jellyfish Filter Inspection and Maintenance Log

Owner: _____ Jellyfish Model No.: _____

Location: _____ GPS Coordinates: _____

Land Use: Commercial: _____ Industrial: _____ Service Station: _____

Road/Highway: _____ Airport: _____ Residential: _____ Parking Lot: _____

Date/Time:					
Inspector:					
Maintenance Contractor:					
Visible Oil Present: (Y/N)					
Oil Quantity Removed					
Floatable Debris Present: (Y/N)					
Floatable Debris removed: (Y/N)					
Water Depth in Backwash Pool					
Cartridges externally rinsed/re-commissioned: (Y/N)					
New tentacles put on Cartridges: (Y/N)					
Sediment Depth Measured: (Y/N)					
Sediment Depth (inches or mm):					
Sediment Removed: (Y/N)					
Cartridge Lids intact: (Y/N)					
Observed Damage:					
Comments:					

CDS Guide

Operation, Design, Performance and Maintenance



CDS®

Using patented continuous deflective separation technology, the CDS system screens, separates and traps debris, sediment, and oil and grease from stormwater runoff. The indirect screening capability of the system allows for 100% removal of floatables and neutrally buoyant material without blinding. Flow and screening controls physically separate captured solids, and minimize the re-suspension and release of previously trapped pollutants. Inline units can treat up to 6 cfs, and internally bypass flows in excess of 50 cfs (1416 L/s). Available precast or cast-in-place, offline units can treat flows from 1 to 300 cfs (28.3 to 8495 L/s). The pollutant removal capacity of the CDS system has been proven in lab and field testing.

Operation Overview

Stormwater enters the diversion chamber where the diversion weir guides the flow into the unit's separation chamber and pollutants are removed from the flow. All flows up to the system's treatment design capacity enter the separation chamber and are treated.

Swirl concentration and screen deflection force floatables and solids to the center of the separation chamber where 100% of floatables and neutrally buoyant debris larger than the screen apertures are trapped.

Stormwater then moves through the separation screen, under the oil baffle and exits the system. The separation screen remains clog free due to continuous deflection.

During the flow events exceeding the treatment design capacity, the diversion weir bypasses excessive flows around the separation chamber, so captured pollutants are retained in the separation cylinder.

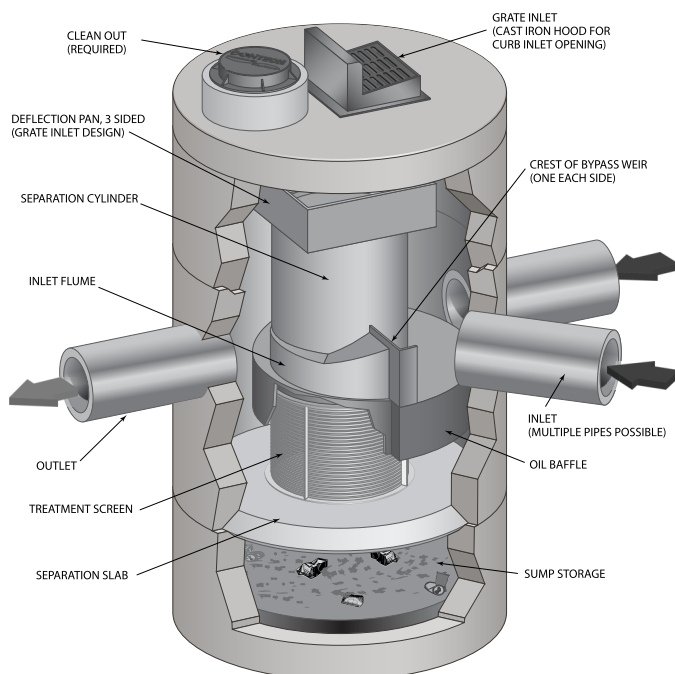

Design Basics

There are three primary methods of sizing a CDS system. The Water Quality Flow Rate Method determines which model size provides the desired removal efficiency at a given flow rate for a defined particle size. The Rational Rainfall Method™ or the Probabilistic Method is used when a specific removal efficiency of the net annual sediment load is required.

Typically in the United States, CDS systems are designed to achieve an 80% annual solids load reduction based on lab generated performance curves for a gradation with an average particle size (d50) of 125 microns (μm). For some regulatory environments, CDS systems can also be designed to achieve an 80% annual solids load reduction based on an average particle size (d50) of 75 microns (μm) or 50 microns (μm).

Water Quality Flow Rate Method

In some cases, regulations require that a specific treatment rate, often referred to as the water quality design flow (WQQ), be treated. This WQQ represents the peak flow rate from either an event with a specific recurrence interval, e.g. the six-month storm, or a water quality depth, e.g. 1/2-inch (13 mm) of rainfall.

The CDS is designed to treat all flows up to the WQQ. At influent rates higher than the WQQ, the diversion weir will direct most flow exceeding the WQQ around the separation chamber. This allows removal efficiency to remain relatively constant in the separation chamber and eliminates the risk of washout during bypass flows regardless of influent flow rates.

Treatment flow rates are defined as the rate at which the CDS will remove a specific gradation of sediment at a specific removal efficiency. Therefore the treatment flow rate is variable, based on the gradation and removal efficiency specified by the design engineer.

Rational Rainfall Method™

Differences in local climate, topography and scale make every site hydraulically unique. It is important to take these factors into consideration when estimating the long-term performance of any stormwater treatment system. The Rational Rainfall Method combines site-specific information with laboratory generated performance data, and local historical precipitation records to estimate removal efficiencies as accurately as possible.

Short duration rain gauge records from across the United States and Canada were analyzed to determine the percent of the total annual rainfall that fell at a range of intensities. US stations' depths were totaled every 15 minutes, or hourly, and recorded in 0.01-inch increments. Depths were recorded hourly with 1-mm resolution at Canadian stations. One trend was consistent at all sites; the vast majority of precipitation fell at low intensities and high intensity storms contributed relatively little to the total annual depth.

These intensities, along with the total drainage area and runoff coefficient for each specific site, are translated into flow rates using the Rational Rainfall Method. Since most sites are relatively small and highly impervious, the Rational Rainfall Method is appropriate. Based on the runoff flow rates calculated for each intensity, operating rates within a proposed CDS system are

determined. Performance efficiency curve determined from full scale laboratory tests on defined sediment PSDs is applied to calculate solids removal efficiency. The relative removal efficiency at each operating rate is added to produce a net annual pollutant removal efficiency estimate.

Probabilistic Rational Method

The Probabilistic Rational Method is a sizing program Contech developed to estimate a net annual sediment load reduction for a particular CDS model based on site size, site runoff coefficient, regional rainfall intensity distribution, and anticipated pollutant characteristics.

The Probabilistic Method is an extension of the Rational Method used to estimate peak discharge rates generated by storm events of varying statistical return frequencies (e.g. 2-year storm event). Under the Rational Method, an adjustment factor is used to adjust the runoff coefficient estimated for the 10-year event, correlating a known hydrologic parameter with the target storm event. The rainfall intensities vary depending on the return frequency of the storm event under consideration. In general, these two frequency dependent parameters (rainfall intensity and runoff coefficient) increase as the return frequency increases while the drainage area remains constant.

These intensities, along with the total drainage area and runoff coefficient for each specific site, are translated into flow rates using the Rational Method. Since most sites are relatively small and highly impervious, the Rational Method is appropriate. Based on the runoff flow rates calculated for each intensity, operating rates within a proposed CDS are determined. Performance efficiency curve on defined sediment PSDs is applied to calculate solids removal efficiency. The relative removal efficiency at each operating rate is added to produce a net annual pollutant removal efficiency estimate.

Treatment Flow Rate

The inlet throat area is sized to ensure that the WQQ passes through the separation chamber at a water surface elevation equal to the crest of the diversion weir. The diversion weir bypasses excessive flows around the separation chamber, thus preventing re-suspension or re-entrainment of previously captured particles.

Hydraulic Capacity

The hydraulic capacity of a CDS system is determined by the length and height of the diversion weir and by the maximum allowable head in the system. Typical configurations allow hydraulic capacities of up to ten times the treatment flow rate. The crest of the diversion weir may be lowered and the inlet throat may be widened to increase the capacity of the system at a given water surface elevation. The unit is designed to meet project specific hydraulic requirements.

Performance

Full-Scale Laboratory Test Results

A full-scale CDS system (Model CDS2020-5B) was tested at the facility of University of Florida, Gainesville, FL. This CDS unit was evaluated under controlled laboratory conditions of influent flow rate and addition of sediment.

Two different gradations of silica sand material (UF Sediment & OK-110) were used in the CDS performance evaluation. The particle size distributions (PSDs) of the test materials were analyzed using standard method "Gradation ASTM D-422 "Standard Test Method for Particle-Size Analysis of Soils" by a certified laboratory.

UF Sediment is a mixture of three different products produced by the U.S. Silica Company: "Sil-Co-Sil 106", "#1 DRY" and "20/40 Oil Frac". Particle size distribution analysis shows that the UF Sediment has a very fine gradation ($d_{50} = 20$ to $30 \mu\text{m}$) covering a wide size range (Coefficient of Uniformity, C averaged at 10.6). In comparison with the hypothetical TSS gradation specified in the NJDEP (New Jersey Department of Environmental Protection) and NJCAT (New Jersey Corporation for Advanced Technology) protocol for lab testing, the UF Sediment covers a similar range of particle size but with a finer d_{50} (d_{50} for NJDEP is approximately $50 \mu\text{m}$) (NJDEP, 2003).

The OK-110 silica sand is a commercial product of U.S. Silica Sand. The particle size distribution analysis of this material, also included in Figure 1, shows that 99.9% of the OK-110 sand is finer than 250 microns, with a mean particle size (d_{50}) of 106 microns. The PSDs for the test material are shown in Figure 1.

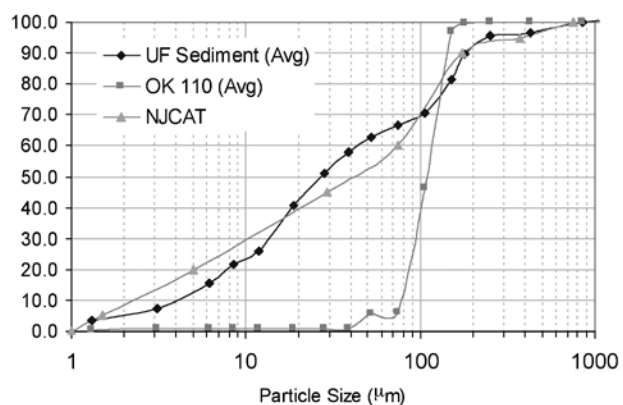

Figure 1. Particle size distributions

Tests were conducted to quantify the performance of a specific CDS unit (1.1 cfs (31.3-L/s) design capacity) at various flow rates, ranging from 1% up to 125% of the treatment design capacity of the unit, using the 2400 micron screen. All tests were conducted with controlled influent concentrations of approximately 200 mg/L. Effluent samples were taken at equal time intervals across the entire duration of each test run. These samples were then processed with a Dekaport Cone sample splitter to obtain representative sub-samples for Suspended Sediment Concentration (SSC) testing using ASTM D3977-97 "Standard Test Methods for Determining Sediment Concentration in Water Samples", and particle size distribution analysis.

Results and Modeling

Based on the data from the University of Florida, a performance model was developed for the CDS system. A regression analysis was used to develop a fitting curve representative of the scattered data points at various design flow rates. This model, which demonstrated good agreement with the laboratory data, can then be used to predict CDS system performance with respect

to SSC removal for any particle size gradation, assuming the particles are inorganic sandy-silt. Figure 2 shows CDS predictive performance for two typical particle size gradations (NJCAT gradation and OK-110 sand) as a function of operating rate.

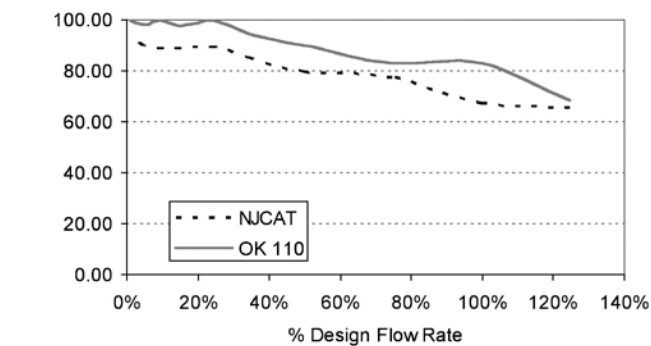

Figure 2. CDS stormwater treatment predictive performance for various particle gradations as a function of operating rate.

Many regulatory jurisdictions set a performance standard for hydrodynamic devices by stating that the devices shall be capable of achieving an 80% removal efficiency for particles having a mean particle size (d50) of 125 microns (e.g. Washington State Department of Ecology — WASDOE - 2008). The model can be used to calculate the expected performance of such a PSD (shown in Figure 3). The model indicates (Figure 4) that the CDS system with 2400 micron screen achieves approximately 80% removal at the design (100%) flow rate, for this particle size distribution (d50 = 125 μ m).

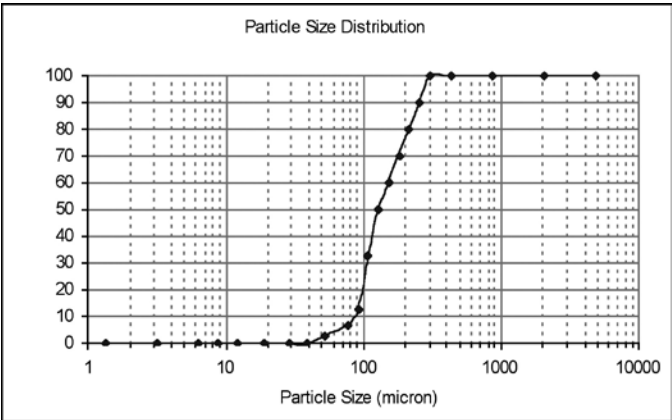

Figure 3. WASDOE PSD

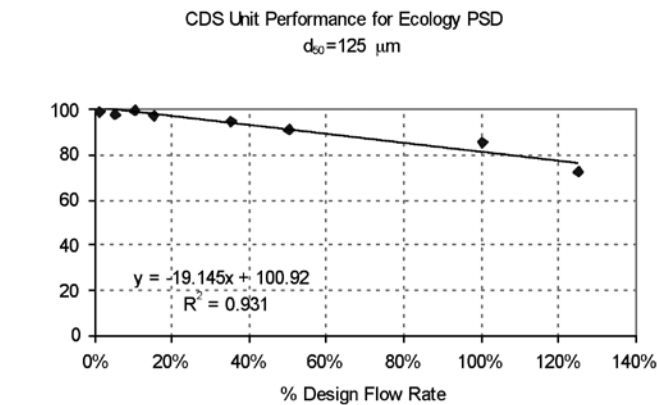

Figure 4. Modeled performance for WASDOE PSD.

Maintenance

The CDS system should be inspected at regular intervals and maintained when necessary to ensure optimum performance. The rate at which the system collects pollutants will depend more heavily on site activities than the size of the unit. For example, unstable soils or heavy winter sanding will cause the grit chamber to fill more quickly but regular sweeping of paved surfaces will slow accumulation.

Inspection

Inspection is the key to effective maintenance and is easily performed. Pollutant transport and deposition may vary from year to year and regular inspections will help ensure that the system is cleaned out at the appropriate time. At a minimum, inspections should be performed twice per year (e.g. spring and fall) however more frequent inspections may be necessary in climates where winter sanding operations may lead to rapid accumulations, or in equipment washdown areas. Installations should also be inspected more frequently where excessive amounts of trash are expected.

The visual inspection should ascertain that the system components are in working order and that there are no blockages or obstructions in the inlet and separation screen. The inspection should also quantify the accumulation of hydrocarbons, trash, and sediment in the system. Measuring pollutant accumulation can be done with a calibrated dipstick, tape measure or other measuring instrument. If absorbent material is used for enhanced removal of hydrocarbons, the level of discoloration of the sorbent material should also be identified



during inspection. It is useful and often required as part of an operating permit to keep a record of each inspection. A simple form for doing so is provided.

Access to the CDS unit is typically achieved through two manhole access covers. One opening allows for inspection and cleanout of the separation chamber (cylinder and screen) and isolated sump. The other allows for inspection and cleanout of sediment captured and retained outside the screen. For deep units, a single manhole access point would allow both sump cleanout and access outside the screen.

The CDS system should be cleaned when the level of sediment has reached 75% of capacity in the isolated sump or when an appreciable level of hydrocarbons and trash has accumulated. If absorbent material is used, it should be replaced when significant discoloration has occurred. Performance will not be impacted until 100% of the sump capacity is exceeded; however, it is recommended that the system be cleaned prior to that for easier removal of sediment. The level of sediment is easily determined by measuring from finished grade down to the top of the sediment pile. To avoid underestimating the level of sediment in the chamber, the measuring device must be lowered to the top of the sediment pile carefully. Particles at the top of the pile typically offer less resistance to the end of the rod than consolidated particles toward the bottom of the pile. Once this measurement is recorded, it should be compared to the as-built drawing for the unit to determine whether the height of the sediment pile off the bottom of the sump floor exceeds 75% of the total height of isolated sump.

Cleaning

Cleaning of a CDS system should be done during dry weather conditions when no flow is entering the system. The use of a vacuum truck is generally the most effective and convenient method of removing pollutants from the system. Simply remove the manhole covers and insert the vacuum hose into the sump. The system should be completely drained down and the sump fully evacuated of sediment. The area outside the screen should also be cleaned out if pollutant build-up exists in this area.

In installations where the risk of petroleum spills is small, liquid contaminants may not accumulate as quickly as sediment. However, the system should be cleaned out immediately in the event of an oil or gasoline spill. Motor oil and other hydrocarbons that accumulate on a more routine basis should be removed when an appreciable layer has been captured. To remove these pollutants, it may be preferable to use absorbent pads since they are usually less expensive to dispose than the oil/water emulsion that may be created by vacuuming the oily layer. Trash and debris can be netted out to separate it from the other pollutants. The screen should be cleaned to ensure it is free of trash and debris.

Manhole covers should be securely seated following cleaning activities to prevent leakage of runoff into the system from above and also to ensure that proper safety precautions have been followed. Confined space entry procedures need to be followed if physical access is required. Disposal of all material removed from the CDS system should be done in accordance with local regulations. In many jurisdictions, disposal of the sediments may be handled in the same manner as the disposal of sediments removed from catch basins or deep sump manholes. Check your local regulations for specific requirements on disposal.

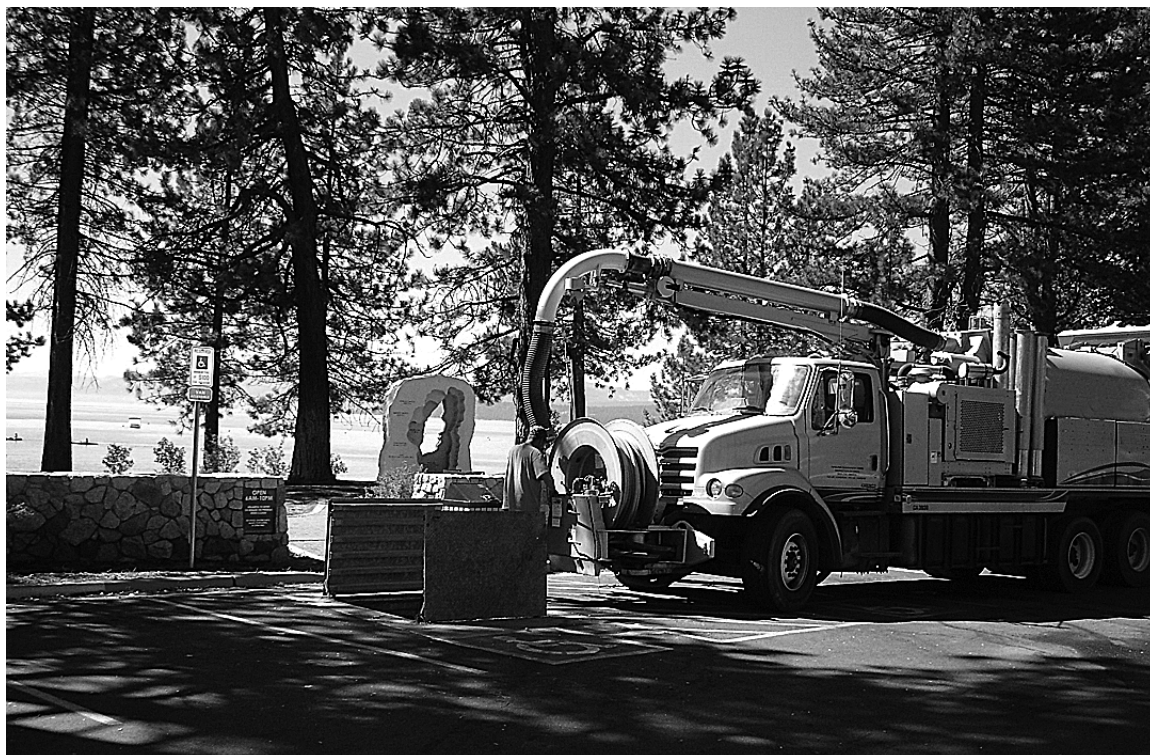

CDS Model	Diameter		Distance from Water Surface to Top of Sediment Pile		Sediment Storage Capacity	
	ft	m	ft	m	y ³	m ³
CDS1515	3	0.9	3.0	0.9	0.5	0.4
CDS2015	4	1.2	3.0	0.9	0.9	0.7
CDS2015	5	1.5	3.0	0.9	1.3	1.0
CDS2020	5	1.5	3.5	1.1	1.3	1.0
CDS2025	5	1.5	4.0	1.2	1.3	1.0
CDS3020	6	1.8	4.0	1.2	2.1	1.6
CDS3025	6	1.8	4.0	1.2	2.1	1.6
CDS3030	6	1.8	4.6	1.4	2.1	1.6
CDS3035	6	1.8	5.0	1.5	2.1	1.6
CDS4030	8	2.4	4.6	1.4	5.6	4.3
CDS4040	8	2.4	5.7	1.7	5.6	4.3
CDS4045	8	2.4	6.2	1.9	5.6	4.3
CDS5640	10	3.0	6.3	1.9	8.7	6.7
CDS5653	10	3.0	7.7	2.3	8.7	6.7
CDS5668	10	3.0	9.3	2.8	8.7	6.7
CDS5678	10	3.0	10.3	3.1	8.7	6.7

Table 1: CDS Maintenance Indicators and Sediment Storage Capacities

Note: To avoid underestimating the volume of sediment in the chamber, carefully lower the measuring device to the top of the sediment pile. Finer silty particles at the top of the pile may be more difficult to feel with a measuring stick. These finer particles typically offer less resistance to the end of the rod than larger particles toward the bottom of the pile.

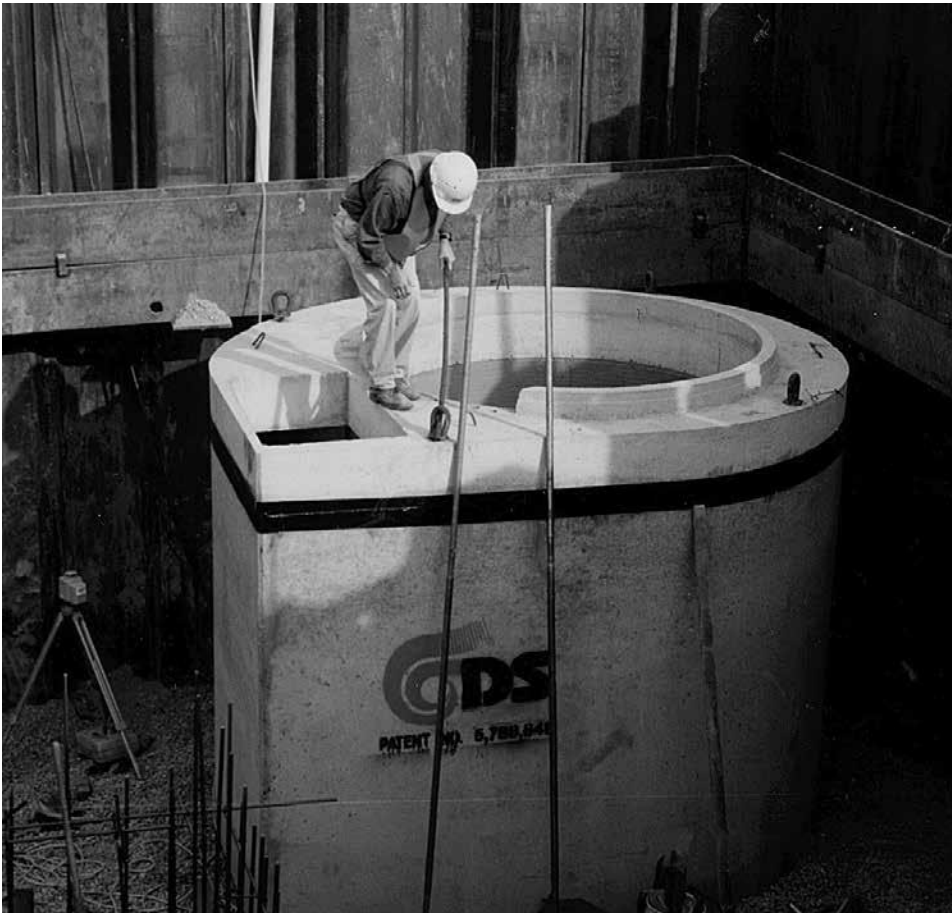

CDS Inspection & Maintenance Log

CDS Model: _____ Location: _____

[illegible]

1. The water depth to sediment is determined by taking two measurements with a stadia rod: one measurement from the manhole opening to the top of the sediment pile and the other from the manhole opening to the water surface. If the difference between these measurements is less than the values listed in table 1 the system should be cleaned out. **Note: to avoid underestimating the volume of sediment in the chamber, the measuring device must be carefully lowered to the top of the sediment pile.**
2. For optimum performance, the system should be cleaned out when the floating hydrocarbon layer accumulates to an appreciable thickness. In the event of an oil spill, the system should be cleaned immediately.

SUPPORT

- Drawings and specifications are available at www.ContechES.com.
- Site-specific design support is available from our engineers.



800-338-1122
www.ContechES.com

©2017 Contech Engineered Solutions LLC, a QUIKRETE Company

Contech Engineered Solutions provides site solutions for the civil engineering industry. Contech's portfolio includes bridges, drainage, sanitary sewer, earth stabilization and stormwater treatment products. For information on other Contech division offerings, visit www.ContechES.com or call 800.338.1122

NOTHING IN THIS CATALOG SHOULD BE CONSTRUED AS A WARRANTY. APPLICATIONS SUGGESTED HEREIN ARE DESCRIBED ONLY TO HELP READERS MAKE THEIR OWN EVALUATIONS AND DECISIONS, AND ARE NEITHER GUARANTEES NOR WARRANTIES OF SUITABILITY FOR ANY APPLICATION. CONTECH MAKES NO WARRANTY WHATSOEVER, EXPRESS OR IMPLIED, RELATED TO THE APPLICATIONS, MATERIALS, COATINGS, OR PRODUCTS DISCUSSED HEREIN. ALL IMPLIED WARRANTIES OF MERCHANTABILITY AND ALL IMPLIED WARRANTIES OF FITNESS FOR ANY PARTICULAR PURPOSE ARE DISCLAIMED BY CONTECH. SEE CONTECH'S CONDITIONS OF SALE (AVAILABLE AT WWW.CONTECHES.COM/COS) FOR MORE INFORMATION.

The product(s) described may be protected by one or more of the following US patents: 5,322,629; 5,624,576; 5,707,527; 5,759,415; 5,788,848; 5,985,157; 6,027,639; 6,350,374; 6,406,218; 6,641,720; 6,511,595; 6,649,048; 6,991,114; 6,998,038; 7,186,058; 7,296,692; 7,297,266; related foreign patents or other patents pending.