

KEY PLAN

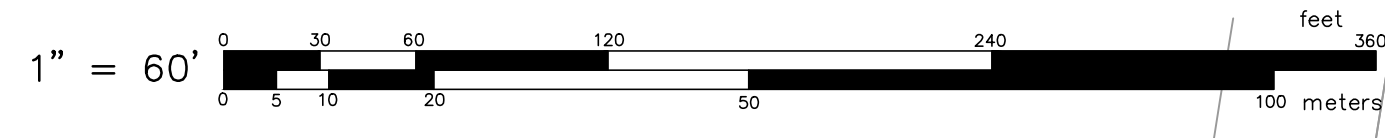

**SITE LAYOUT PANEL - 3**  
FOR  
FINAL OVERALL DISTRICT PLAN FOR  
**CRANSTON CROSSING**  
(A.P. 15-1, LOT 9 AND A.P. 15-4, LOTS 8 & 1706)  
SITUATED AT  
**1000 NEW LONDON AVENUE**  
CRANSTON, RI  
PREPARED FOR  
**COASTAL PARTNERS LLC**

NO.	REVISION	BY	DATE
1	LAYOUT UPDATE PER CLIENT	KYY	09/25/20
2	ENTRANCE UPDATE	KYY	10/16/20

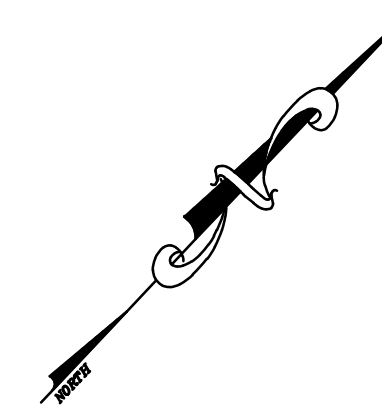
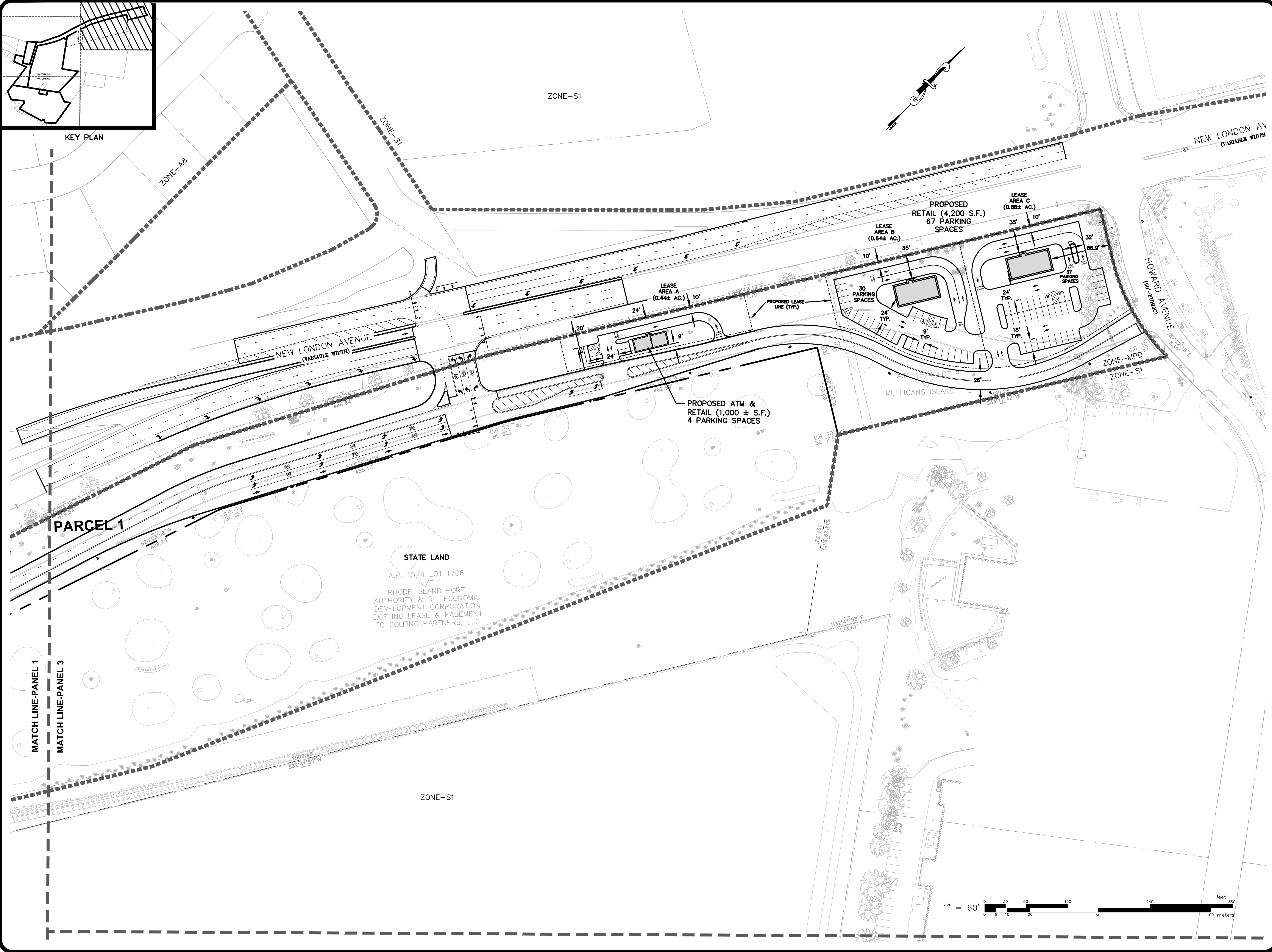
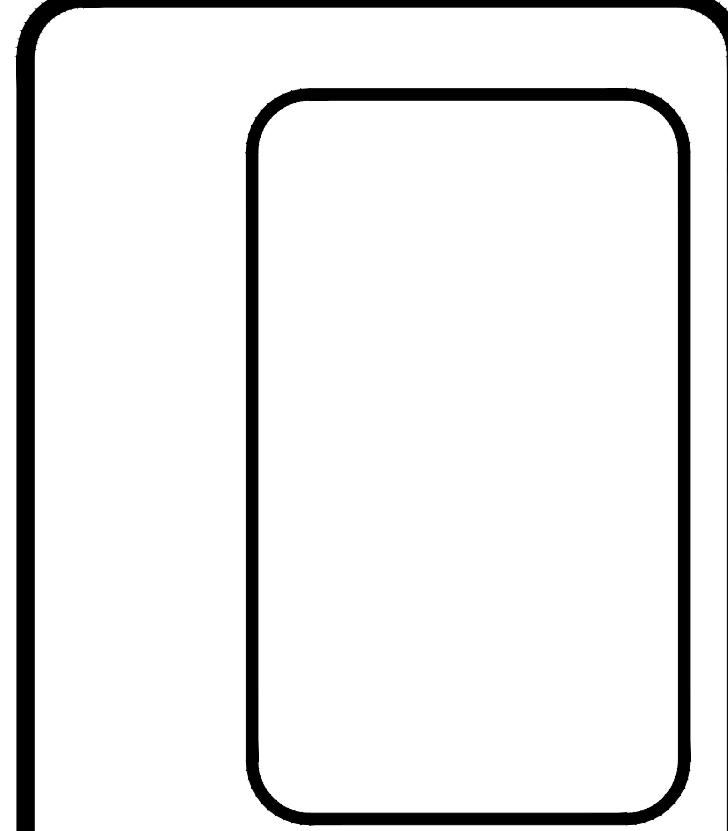

**GAROFALO**  
GAROFALO & ASSOCIATES, INC.  
CIVIL & STRUCTURAL ENGINEERS/SURVEYORS  
LAND PLANNERS/ENVIRONMENTAL SCIENTISTS

85 CORLISS STREET  
P.O. BOX 6145  
PROVIDENCE, R.I. 02940  
TEL. 401-273-6000

Garofalo & Associates ©  
These drawings are the property of  
the engineer/surveyor and have been  
prepared for the use of the client.  
No part of this drawing can be used  
for any other purpose, location or  
condition of this owner or one of its  
directors.

JOB NO. 7268-00	DRAWN BY: KYY
DWG. NO. 7268-00-Base.dwg	CHECKED BY: SSH
SCALE: AS SHOWN	APPROVED: SBG
	DATE: JULY 17, 2020

SHEET  
**C-203**  
11 OF 15 SHEETS

L:\7268-00\_Mulligans Island (Coastal Partners) - Cranston, RI.dwg\01-Curren\7268-Base.dwg 10/16/2020 KYY 17:04